

## BM100

solid sprung door handle on hidden rose

### Product information

Code: 3201D001INXX0

Finish: satin stainless steel

UNIT: Pair

Collection: RIBBON

Designer: Bob Manders

EAN code: 8718009258644

### RIBBON by Bob Manders

The RIBBON series is a total concept collection consisting of door, window, and furniture fittings.

### Finishes

- satin stainless steel
- satin black

## BM100

lever handle  
stainless steel

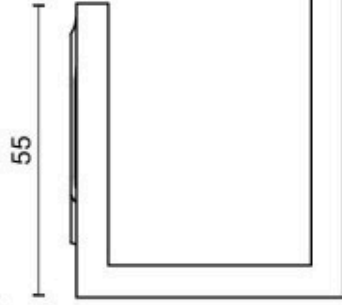

51

6

150



45



150

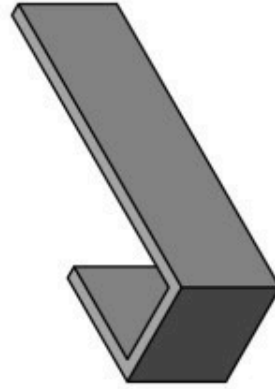

38

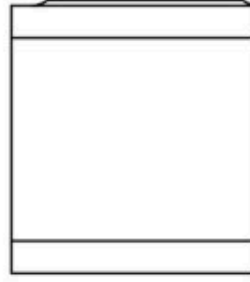

FORMANI®		Part number:	
		Format: A3	
Doc no.: 3201D001 BM100 V02.dwg		Description: BM100	
Drawn by: Christiaan Brimbois      Creation date: 29-8-2014			
Formani Holland B.V. · Amerikalaan 55 · 6199 AE Maastricht Airport · tel: +31 (0)43 308 90 00 · www.formani.nl · info@formani.nl			

# RIBBON

by Bob Manders

**A single piece featuring clean lines, welded together as one whole, defines the design of our RIBBON hardware series by Bob Manders. The unique design is based on the architectural style 'Ribbon', to which the series owes its name, where walls, floors, and roofs join to form a single, self-supporting yet interlinked structure. This results in an unbroken sense of movement and momentum as the areas flow into one another. That same principle can also be observed in the hardware series. Traditional handles are composed of three pieces: the rose, the neck, and the lever. This is how the RIBBON lever handle differs: these three parts are made out of just one single piece, with a unique bayonet fixation system. RIBBON is a comprehensive total concept collection that brings together lever handles, window handles, pull handles, cabinet fittings, and other accessories.**

# RIBBON

by Bob Manders



FORMANI®



# Bob Manders

Geldrop, 1971

Design philosophy: I am writing you a long letter, because I don't have time for a short one... (E.B. Pascal)

**Bob Manders' designs reflect a true understanding of the past and a great fascination for innovation, resulting in a balanced space. The unpredictability and innovativeness of his designs are evident in the FORMANI RIBBON by Bob Manders series. This hardware collection is based on the architectural principle 'RIBBON', where walls, floors, and roof unite within a building to form a single, self-supporting yet interlinked structure. This construction results in a continued sense of movement and momentum as the spaces flow into one another. His passion for innovation is reflected in the way the lever handle is shaped.**

# Brand story

**FORMANI has evolved considerably over the last few decades – from a Dutch family business to an internationally renowned designer brand, from door handles to total design concepts, from product development to collaborations with world-class designers. It was an evolution driven by pure ambition and courage. Our motto, ‘Obsessed with details’, epitomizes everything we do, from product to process, from strategy to service. Because it is these details that make the difference between good and perfect. At FORMANI, good is the enemy of great.**

---

Formani Holland b.v.  
Europalaan 12  
6199 AB  
Maastricht-Airport  
T: +31(0)43 308 9000  
E: [info@formani.com](mailto:info@formani.com)  
Chamber of Commerce:  
146 27 479

**FORMANI®**